

Datasheet

Surge protection for information technology and telecommunication installations

SPD according to test category C2+C1

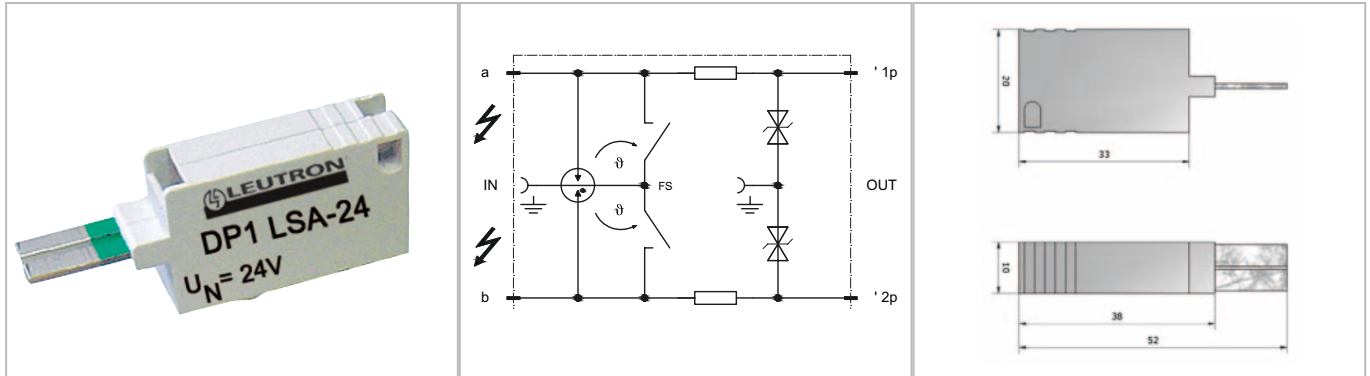

Surge voltage protective module for one pair of wires for measuring and control systems, in LSA (IDC) disconnection modules. The protective module provides coarse and fine protection in LSA systems (construction form 2). Surge voltage protection connector for 1DA, with fail-safe contact.

- Versions for various voltage levels
- Two-step, coarse and fine protection
- Fail-safe thermal overload protection

| Technical Data | | DP 1LSA-24 |
|--|------|---|
| Nominal voltage DC | UN | 24V= |
| Max. continuous operating voltage DC | Uc | 29V= |
| Nominal alternating voltage (50/60Hz) | UN | 15V~ |
| Max. continuous operating voltage AC (50/60Hz) | Uc | 20V~ |
| Nominal operating current at 25°C | IL | 100 mA |
| C2 nominal discharge current (8/20 μs) | In | 5 kA |
| Nominal discharge current (8/20) | In | 10 kA |
| Protection level at In (line-PG) | Up | ≤ 60 V |
| Residual voltage at 1 kV/μs (line-PG) | Ures | ≤ 46 V |
| Response time | tA | ≤ 1 ns |
| Capacitance, line-earth | C | ≤ 1,4 nF |
| Series impedance per line at 25°C | R | 27 Ω |
| Max. transmission frequency | fg | 4,2 MHz |
| Operating temperature range | TU | -25 - +60 °C |
| Earthing (Grounding) by | | via grounding bar and isolation unit on LSA backmount frame |
| Enclosure material / colour | | self-extinguishing thermoplastic (POCAN) UL 94 V0, grey |
| Net weight / pc | | 10 g |

Order Data

| | |
|-------------|------------|
| Product | DP 1LSA-24 |
| Article-No. | 24 00 34 |